



10 Poole Drive, Scunthorpe, DN17 2PE

£249,950

Presented immaculately throughout by the current owner is this three bedroom semi detached bungalow in Bottesford. The property consists of a great size kitchen diner with a separate utility area, lounge, conservatory, two double bedrooms one with an en suite, a great size single bedroom and a further bathroom. Outside there is a great size garden laid mainly with turf and a private courtyard area off the conservatory. There is off road parking to the front on a blocked paved driveway and garage. Available for viewings now please call the office to book your appointment.

Entrance

Kitchen 16'9" x 9'10" (5.12 x 3.02)



Lounge 17'11" x 12'0" (5.47 x 3.67)



Conservatory / Dining room 12'5" x 9'11" (3.79 x 3.04)



Bathroom



Bedroom one 13'6" x 7'8" (4.14 x 2.36)



Bedroom two 10'5" x 9'11" (3.19 x 3.03)



En suite

Bedroom three



Garage 18'3" x 8'0" (5.58 x 2.45)

Outside



Floor Plan

GROUND FLOOR
1211 sq.ft. (112.5 sq.m.) approx.

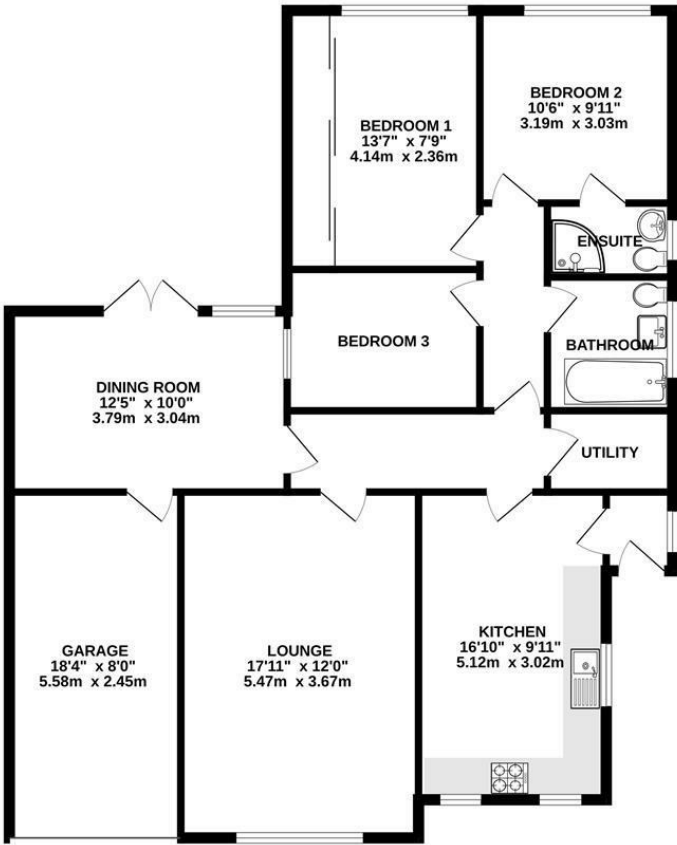

TOTAL FLOOR AREA : 1211 sq.ft. (112.5 sq.m.) approx.
Whilst every attempt has been made to ensure the accuracy of the floorplan contained here, measurements of doors, windows, rooms and any other items are approximate and no responsibility is taken for any error, omission or mis-statement. This plan is for illustrative purposes only and should be used as such by any prospective purchaser. The services, systems and appliances shown have not been tested and no guarantee as to their operability or efficiency can be given.
Made with Metropix 12/2024

Area Map

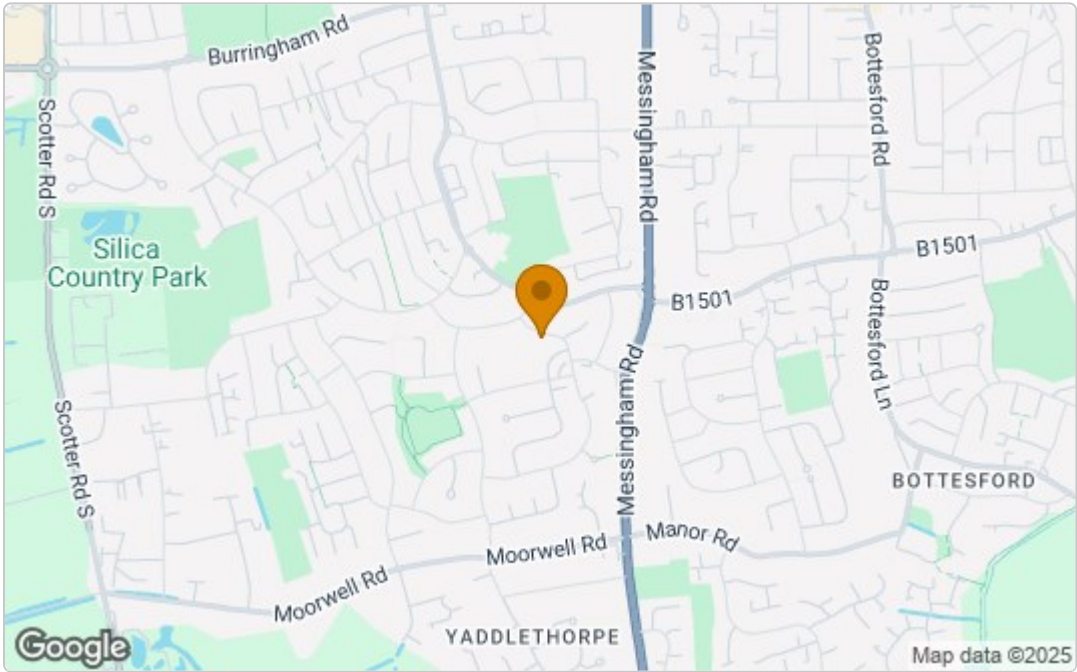

Energy Efficiency Graph

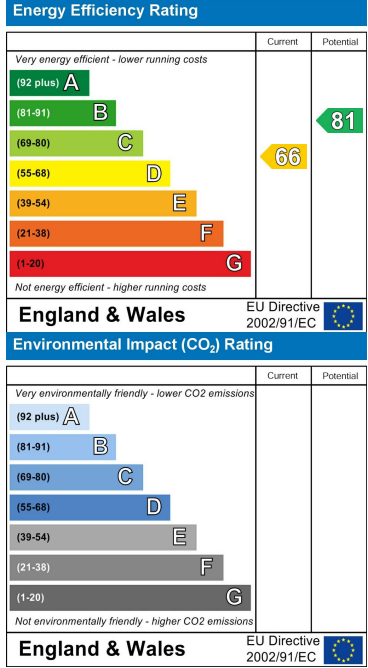

These particulars, whilst believed to be accurate are set out as a general outline only for guidance and do not constitute any part of an offer or contract. Intending purchasers should not rely on them as statements of representation of fact, but must satisfy themselves by inspection or otherwise as to their accuracy. No person in this firms employment has the authority to make or give any representation or warranty in respect of the property.